



# ULTIMATE BUILDER'S KIT FOR GLOCK GEN 3-4

Thank you for purchasing this Timney Trigger. It has been designed and manufactured to provide you with a lifetime of dependable service. Each trigger is hand tested and calibrated on an action specific to your platform before leaving our factory. Please read these instructions fully before you begin installing the trigger, you'll be glad you did.

## TOOLS NEEDED:



Straight Punch or Glock Tool

## TIMNEY TRIGGER GUARANTEE

**Material and workmanship:** This Timney trigger has been carefully inspected, tested and adjusted to give a lifetime of dependable service. Every possible care has been exercised in its design and construction. If any defect in workmanship or material should develop under conditions of normal use and service, any necessary repairs, including parts and labor will be made at NO CHARGE to the purchaser providing that our inspection reveals parts were not damaged through accident, alteration, misuse, abuse or other causes beyond our control. We neither assume nor imply any oral or statutory warranties, and we neither assume nor authorize any person to assume for us any obligation or liability in connection with this trigger. Repairs or disassembly of this trigger in any manner without specific authorization, voids the guarantee.

### PARTS INCLUDED:



Silver Spring: normal reset, baseline spring



Red Spring: more positive reset, firmer spring



C-Washer: must be used in installation

- 1 Before beginning work on any firearm, make sure to remove the ammunition source and double check to ensure the chamber is empty.
- 2 Remove the slide from frame, then using a punch, push out the cross pins.
- 3 Remove the locking block, slide stop, and trigger assembly.
- 4 Remove the trigger, trigger bar, and spring receiver from trigger assembly.
- 5 Loosen the button-head screw in the Glock trigger housing about halfway and then install the Timney sear assembly into the Glock trigger housing.
- 6 Install the c-washer. Then tighten the screw with the 1/16 hex key after pushing in the c-washer all the way in.
- 7 Carefully push out the stock connector from trigger housing and install the Timney connector.
- 8 Slide the return spring (either red or silver) into the small hole on the front of the trigger shoe, then click it into place.

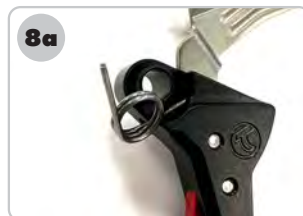
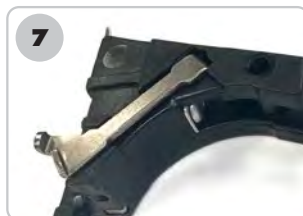
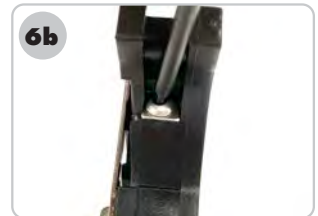
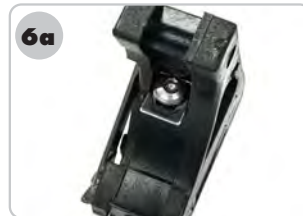
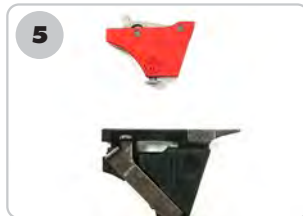
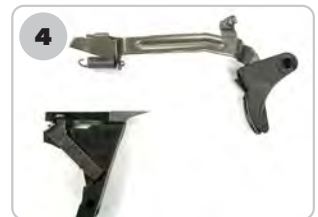
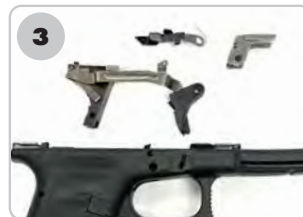

# INSTALLATION INSTRUCTIONS

- 9 Mate the trigger bar with the receiver and insert the trigger assembly into the frame.
- 10 Place the locking block halfway down in the frame, make sure the return spring is toward the magwell before fully inserting the locking block.
- 11 Install the locking block pin from right to left. Place it halfway in, move the return spring towards the magwell, then insert the pin fully.
- 12 Place the slide stop lever on the left side of the return spring.
- 13 Use a Glock tool or punch as guide when replacing the trigger pin; make sure the slide stop sits in the groove of the trigger pin. The trigger pin should move back and forth slightly within the groove.
- 14 Replace the trigger housing pin using straight punch or Glock tool.
- 15 Before replacing the slide, you must install the Timney striker, striker spring, and safety plunger.
- 16 Using a flathead screwdriver or similar, push the striker spacer sleeve down and remove the slide cover plate.
- 17 Remove the striker assembly from the slide and rest on slide as shown.
- 18 With the striker supported, carefully compress the striker spring to remove both sides of the spring cups. Then remove the striker spring, striker, and spacer sleeve from the slide.
- 19 Now you are ready to install your new Timney striker and striker spring!
- 20 Place the spacer sleeve on the Timney striker, then place the Timney striker spring on the striker.
- 21 Rest the striker assembly on the back of the slide as shown, then decompress the striker spring to reinsert the two spring cups. Set aside the complete striker assembly for use later.
- 22 To install the Timney safety plunger and safety plunger spring, first remove the extractor plunger assembly, then remove the extractor by depressing the safety plunger.
- 23 Remove stock safety plunger and safety plunger spring, then install Timney safety plunger and safety plunger spring.
- 24 Push down the new safety plunger to reinsert extractor. Then reinsert extractor assembly and striker assembly.
- 25 Reinstall the slide cover plate by depressing the striker spacer sleeve, then the extractor assembly.
- 26 Perform a safety and function check.
- 27 You are now ready to enjoy your new Ultimate Builder's Kit!



**IF YOU HAVE TROUBLE CHECK OUT TROUBLESHOOTING STEPS ON [WWW.TIMNEYTRIGGERS.COM](http://WWW.TIMNEYTRIGGERS.COM) OR CONTACT US**

Need help with your install? Contact our customer service team via email or phone for assistance.

Phone: 623-223-1111 Fax: 623-223-1112 Support: [technicalsupport@timneyusa.com](mailto:technicalsupport@timneyusa.com)



# PARTS OVERVIEW



- 1** Slide cover plate
- 2** Slide assembly
- 3** Extractor assembly
- 4** Striker assembly
- 5** Slide stop lever
- 6** Safety plunger
- 7** Trigger housing pin
- 8** Trigger assembly  
(trigger mechanism housing,  
connector, trigger bar, trigger)
- 9** Locking block
- 10** Locking block pin
- 11** Trigger pin
- 12** Frame

**IF YOU HAVE TROUBLE CHECK OUT TROUBLESHOOTING STEPS ON [WWW.TIMNEYTRIGGERS.COM](http://WWW.TIMNEYTRIGGERS.COM) OR CONTACT US**

Need help with your install? Contact our customer service team via email or phone for assistance.

Phone: 623-223-1111 Fax: 623-223-1112 Support: [technicalsupport@timneyusa.com](mailto:technicalsupport@timneyusa.com)

